

W

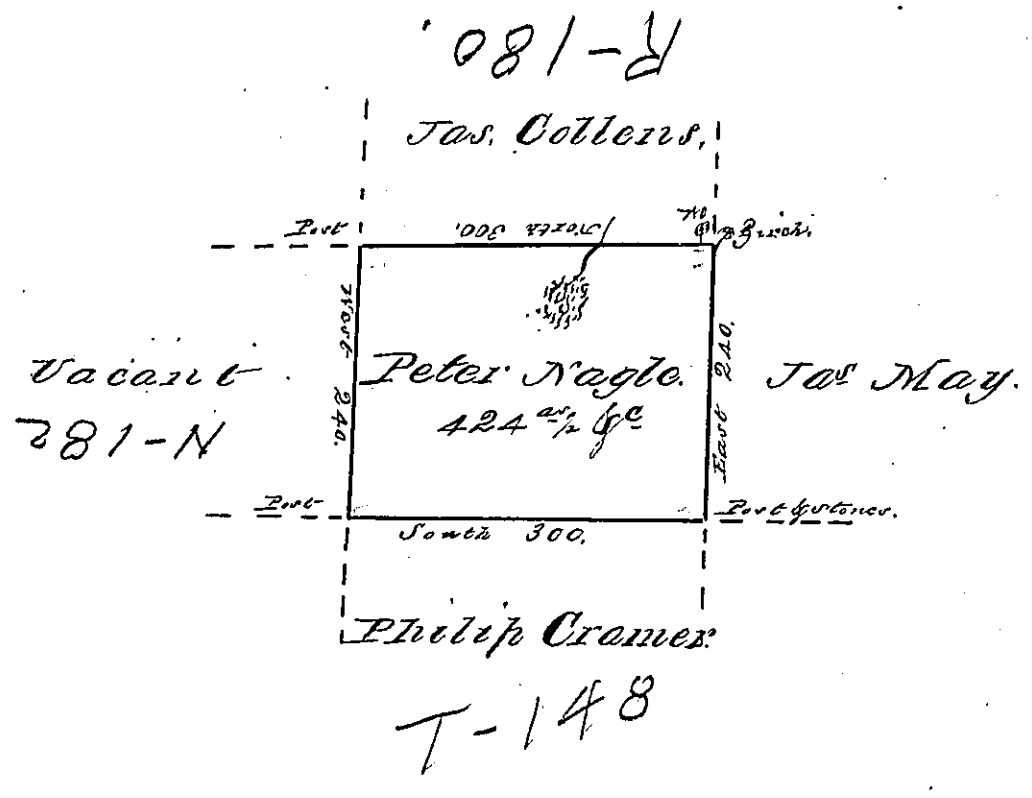

A Draft of a tract of land called Situate
 in the County of Luzerne containing four
 Hundred & twenty four acres 1/2 of allw^e
 Surveyed for Peter Nagle Esq^r the 16th
 day of August 1793, in pursuance of
 a warrant dated the 4th day of January
 1793.

by Wm Gray Esq^r
 To Daniel Brodhead Esq^r
 Sur^r Genl.

IN TESTIMONY that the above is a copy of the original remaining on file in the
 Department of Internal Affairs of Pennsylvania, made con-
 formably to an Act of Assembly approved the 16th day of
 February, 1833, I have hereunto set my Hand and caused
 the Seal of said Department to be affixed at Harrisburg, this

First day of March 1877

Wm Maudslayi
 Secretary of Internal Affairs